

Ventless Hood System

- **Compact and versatile** – one-of-a-kind stainless steel hood provides the necessary vapor removal requirements for all current electric models of Broaster® pressure fryers.
- **Simple to install** – eliminates the need for expensive roof modifications and the hassles of dealing with multiple vendors supplying separate hood and electrical systems.
- **Safe** – includes built-in Ansul R-102A fire suppression system with piping, nozzles (appliance and plenum), and conduit routing the fusible link cable through the hood.
- **Effective** – 3-stage air filtration system includes:
 - 1 stainless steel baffle filter for trapping large grease particles
 - 2 electrostatic air cleaning filter (EAC) with ionizers for charging particles in the grease laden air and electrostatic plates for particle collection
 - 3 disposable charcoal filter for eliminating odors
- **Complete** – shipped with one of each of the following: baffle filter, charcoal filter, EAC filter, EAC soak tank, EAC dry tank, manual.

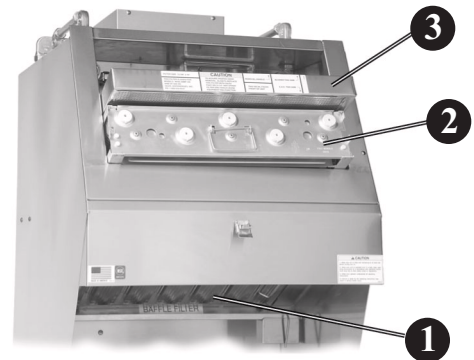

The perfect solution for operations where a conventional hood system is not practical.

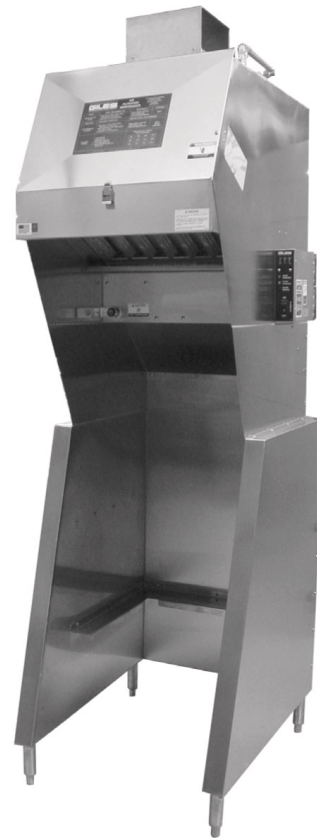

Ventless Hood System

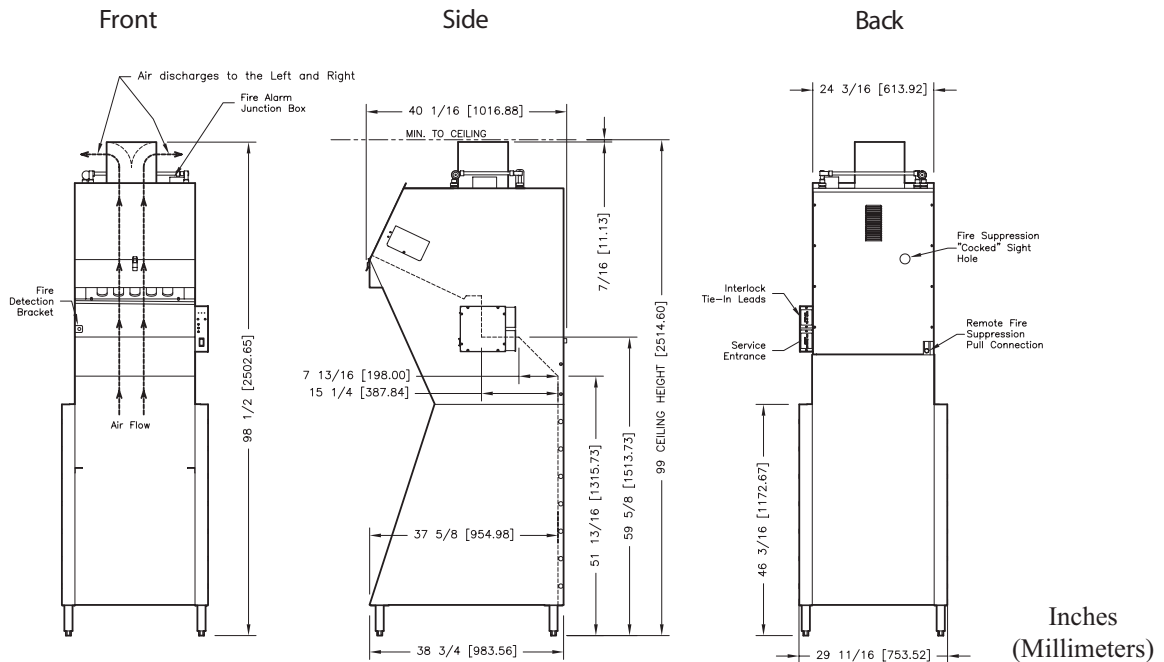

SPECIFICATIONS

Construction

20 gauge to 16 gauge stainless steel

Overall Dimensions

Width: 29-11/16" (753.5 mm)

Depth: 38-3/4" (983.6 mm)

Height: 98-1/2" (2502.7 mm)

Ventless Hood

Exhaust: 510 - 680 cfm

Decibel Level: approx. 65 decibels

Electrical Specifications

Available voltages: 208 volt, 1 ph, 60 hz, 5.5 amps
240 volt, 1 ph, 60 hz, 5.5 amps
(no service cord provided)

Shipping Specifications

Crated Weight: 535 lbs. (243 kg)

Crated Cube Size: 42" D x 52" H x 107" L = 136 cu. ft.
(1067 mm x 1321 mm x 2718 mm = 3.85 cu. m.)

PART NUMBERS

208v Ventless Hood System	93424
240v Ventless Hood System	93425
208v Ventless Hood System with ILS*	93426
240v Ventless Hood System with ILS*	93427

* Interlocking Start Option – shuts down the ventilation hood system if the fryer underneath is not operating. Check with your local officials to see if this is required in your area. If not specified, a non-ILS unit will be provided.

Unit Ships with the Following Accessories:

Baffle Filter	93433
Charcoal Filter	93432
EAC Filter	93431
EAC Soak Tank w/o Cover	93428
EAC Soak Tank Cover	93429
EAC Dry Tank w/o Cover	93430

Additional quantities are available at extra charge.

